

TIMKEN

The Timken Company
4500 Mt Pleasant St. NW
N. Canton, OH 44720

Phone: (234) 262-3000

E-Mail: CustomerCAD@timken.com • Web site: www.timken.com

Part Number 6008-2RS-NR, Deep Groove Ball Bearings (6000, 6200, 6300, 6400)

Timken's deep groove ball bearings deliver reliable performance in a wide range of applications and conditions. With super-finished raceways and controlled geometries, our premium design helps ensure consistent quality.



[Specifications](#) | [Dimensions](#) | [Basic Load Ratings](#) | [Factors](#)

Specifications

Clearance	C0 (Normal)
Bore Size d	40.000 mm
Features	Contact Seals With Snap Ring
Bearing Type	Standard DGBB
Weight	0.190 Kg

Dimensions

Outside Diameter D	68.000 mm
Outside Ring Width B	15.000 mm



Radius Rs min	1.000 mm
Snap Ring Diameter D2 max	74.600 mm
Snap Ring Width f max	1.700 mm

Basic Load Ratings

Cr - Dynamic Load Rating	16.8 kN
C0r - Static Load Rating	11.5 kN

Factors

Grease Reference Speed	10000 rpm
Oil Reference Speed	15000 rpm

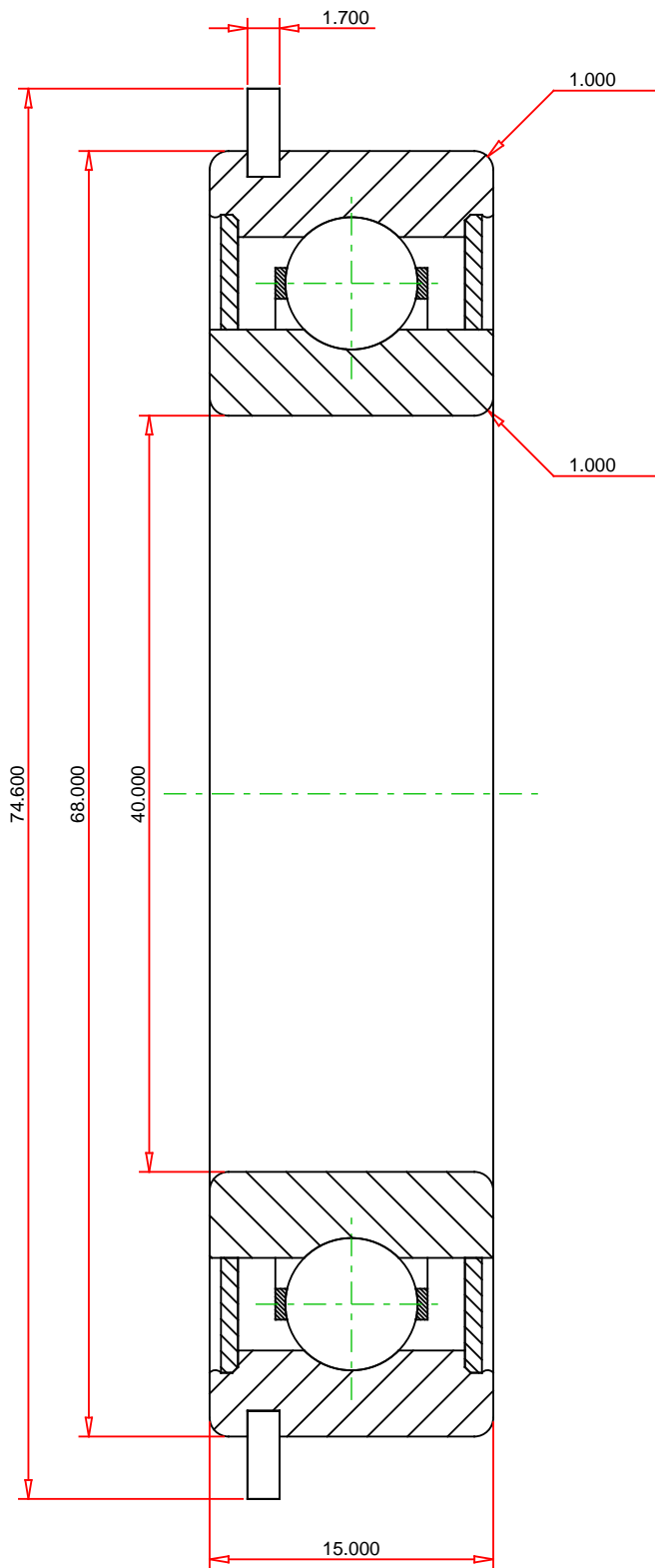

METRIC UNITS

Weight 0.19 kg



THE TIMKEN COMPANY
NORTH CANTON, OHIO USA

6008-2RS-NR
Deep Groove Ball Bearings (6000, 6200, 6300, 6400)

Dynamic Load Rating 16800 N
Static Load Rating 11500 N

Every reasonable effort has been made to ensure the accuracy of the information contained in this writing, but no liability is accepted for errors, omissions or for any other reason.

FOR DISCUSSION ONLY